

Important Instructions:

- Switch off the appliances, and plug out before Disassembly
- Ensure that the blade is fitted before beginning the procedure.

How to Replace Jar Coupler

1. Hold Blade assembly with a soft cloth using your hand.
2. Loosen Jar Coupler in a clockwise direction, using jar coupler tools
3. Once Loose, unscrew jar Coupler by hand and remove it.
4. Fix new jar Coupler onto spindle by screwing it in an anti-clockwise direction by hand.
5. Tighten Jar Coupler in an -Clockwise direction using jar tool.

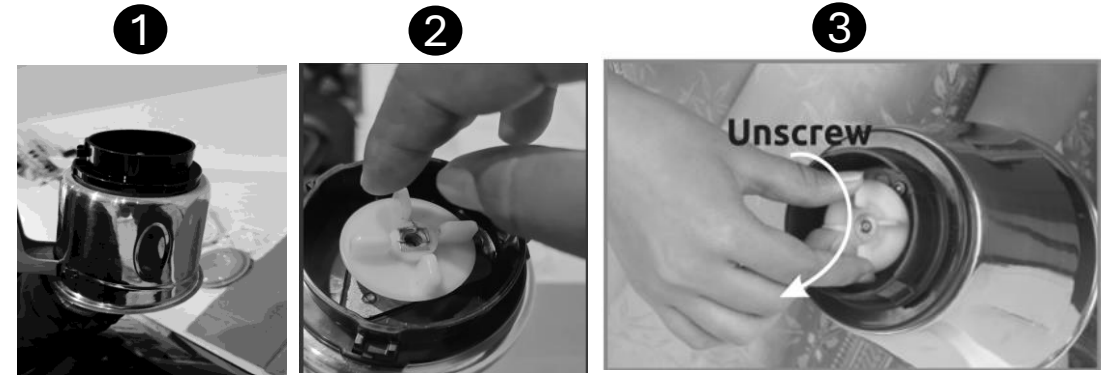

New Jar coupler

